

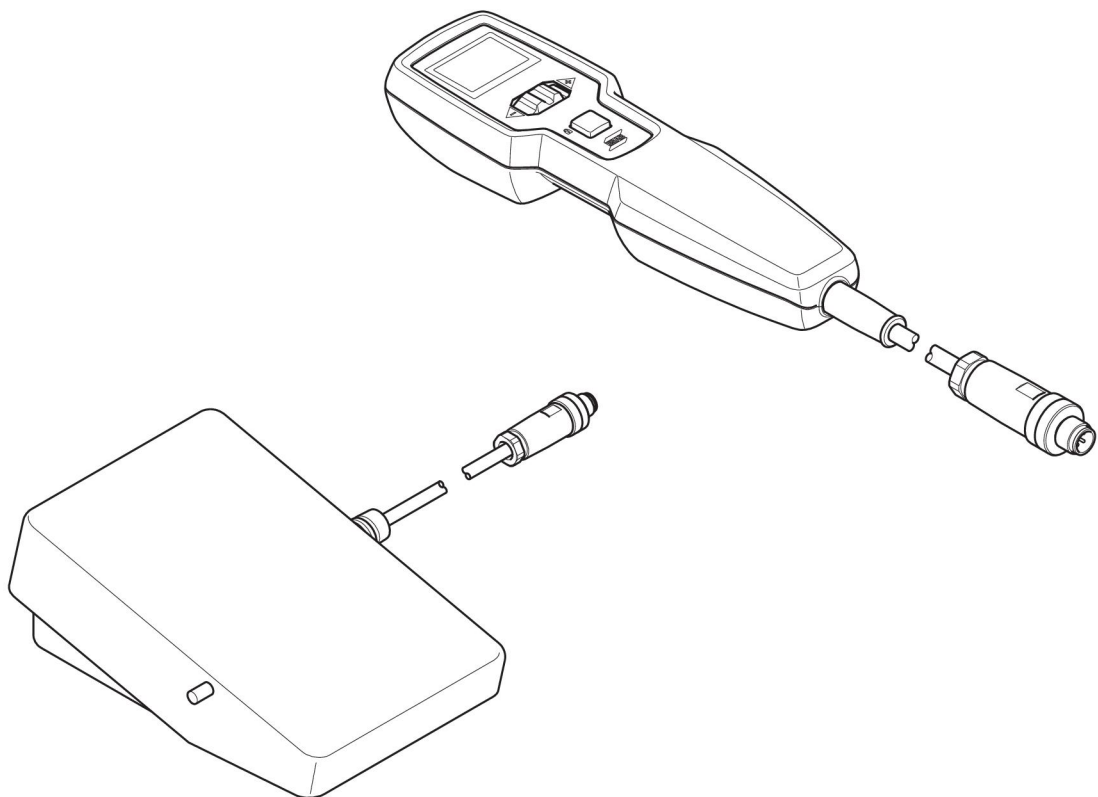

# ***ER 1, ER 1F***

## ***Remote controls***



## **Instruction manual**



## EU DECLARATION OF CONFORMITY

According to  
The Low Voltage Directive 2014/35/EU, entering into force 20 April 2016  
The EMC Directive 2014/30/EU, entering into force 20 April 2016  
The RoHS Directive 2011/65/EU, entering into force 2 January 2013

**Type of equipment**  
Remote Control Unit

**Type designation**  
ER 1F from serial number 705 xxx xxxx (2017 w/05)  
ER 1 from serial number 705 xxx xxxx (2017 w/05)

**Brand name or trade mark**  
ESAB

**Manufacturer or his authorised representative established within the EEA**  
**Name, address, and telephone No:**  
ESAB AB  
Lindholmsallén 9, Box 8004, SE-402 77 Göteborg, Sweden  
Phone: +46 31 50 90 00, Fax: +46 31 50 92 22

**The following harmonised standard in force within the EEA has been used in the design:**  
EN 60974-1:2017, Arc Welding Equipment – Part 1: Welding Power Sources  
EN 60974-10:2014/A1:2015, Arc Welding Equipment – Part 10: Electromagnetic Compatibility (EMC) requirements

**Additional Information:**  
Restrictive use, Class A equipment, intended for use in location other than residential

**By signing this document, the undersigned declares as manufacturer, or the manufacturer's authorised representative established within the EEA, that the equipment in question complies with the safety requirements stated above.**

**Date**

**Signature**

**Position**

Gothenburg  
2017-05-03

Stephen Argo

Global Director Equipment

CE 2017

TABLE OF CONTENTS

---

<b>1</b>	<b>INTRODUCTION</b> .....	<b>4</b>
1.1	Equipment .....	4
1.2	Meaning of symbols .....	4
<b>2</b>	<b>TECHNICAL DATA</b> .....	<b>6</b>
<b>3</b>	<b>OPERATION ER 1</b> .....	<b>7</b>
3.1	Start up .....	7
3.2	The remote control menu .....	7
3.3	Activate the remote control .....	8
3.4	Set value .....	8
3.5	Activate and deactivate memory .....	8
3.6	Lock and unlock the remote control .....	9
3.7	Deactivate the remote control .....	9
<b>4</b>	<b>OPERATION ER 1F</b> .....	<b>10</b>
4.1	Start up .....	10
4.2	Activate the foot pedal .....	10
4.3	Deactivate the foot pedal .....	10
<b>5</b>	<b>MAINTENANCE</b> .....	<b>11</b>
5.1	Replace cable ER 1 .....	11
5.2	Replace cable ER 1F .....	12
<b>6</b>	<b>TROUBLESHOOTING</b> .....	<b>13</b>
<b>7</b>	<b>ORDERING NUMBERS</b> .....	<b>14</b>
<b>8</b>	<b>ORDERING SPARE PARTS</b> .....	<b>15</b>
<b>9</b>	<b>ACCESSORIES</b> .....	<b>16</b>

# 1 INTRODUCTION

---

The remote control ER 1 can be used to control current, arc force and memory selection. The available functions and number of memories depend on the power source the remote control is connected to.

The foot pedal ER 1F can be used to control current. It also has a trigger function, which can be used for weld start.

**ESAB accessories for the product can be found in the "ACCESSORIES" chapter of this manual.**

## 1.1 Equipment

The ER 1 remote control is supplied with:

- 5 m (16.4 ft) connection cable
- instruction manual

The ER 1F remote control (foot pedal) is supplied with:

- 5 m (16.4 ft) connection cable
- instruction manual

## 1.2 Meaning of symbols

**As used throughout this manual: Means Attention! Be Alert!**



### **DANGER!**

Means immediate hazards which, if not avoided, will result in immediate, serious personal injury or loss of life.



### **WARNING!**

Means potential hazards which could result in personal injury or loss of life.



### **CAUTION!**

Means hazards which could result in minor personal injury.



### **WARNING!**

Before use, read and understand the instruction manual and follow all labels, employer's safety practices and Safety Data Sheets (SDSs).





**NOTE!**

**Dispose of electronic equipment at the recycling facility!**

In observance of European Directive 2012/19/EC on Waste Electrical and Electronic Equipment and its implementation in accordance with national law, electrical and/or electronic equipment that has reached the end of its life must be disposed of at a recycling facility.

As the person responsible for the equipment, it is your responsibility to obtain information on approved collection stations.

For further information contact the nearest ESAB dealer.



---

## 2 TECHNICAL DATA

---

	<b>ER 1</b>	<b>ER 1F</b>
<b>Operating voltage</b>	12–24 V DC	12–24 V DC
<b>Dimensions L × W × H</b>	205 × 59 × 38 mm ±10% (8.0 × 2.3 × 1.5 in. ±10%)	225 × 152 × 82 mm ±10% (8.9 × 6.0 × 3.2 in. ±10%)
<b>Weight</b> unit with 5 meter (16.4 ft) cable	475 g (1.05 lb)	2250 g (4.96 lb)
<b>Operating temperature</b>	-20 to +60 °C (-4 to 140 °F)	-20 to +60 °C (-4 to 140 °F)
<b>Transportation temperature</b>	-40 to +80 °C (-40 to 176 °F)	-40 to +80 °C (-40 to 176 °F)
<b>Enclosure class</b>	IP53	IP23

## 3 OPERATION ER 1









### 3.1 Start up

Connection of the remote control to the power source is described in the instruction manual for the power source.

The software version of the remote control is shown during the startup sequence of the remote control.

### 3.2 The remote control menu

Symbols shown in the remote control display (1)

<b>A</b>	Current
	Arc Force
	Soft/Crisp
<b>M</b>	Memory
	Pulse peak current
	Pulse background current
	Locked
	Unlocked
	USB mode active on the power source. No changes can be made from the remote control while this symbol is shown.
	The power source panel is active. No changes can be made from the remote control. The remote control is inactive.

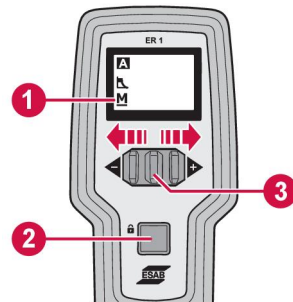

1. Symbols shown in the remote control display
2. Button for activation of functions
3. Wheel for value adjustment



#### NOTE!

The available functions and number of memories depend on the power source the remote control is connected to.

### 3.3 Activate the remote control

**When connected to a power source with manual activation:**

1. Activate the remote control from the power source as described in the instruction manual for the power source.
2. The power source panel will be locked for interaction, but will reflect the changes made on the remote control.



**When connected to a power source with automatic activation:**

1. The remote control is activated when connected to the power source.
2. The power source panel will be active together with the remote control. Both displays will reflect the changes made.

The remote control display reflects all supported changes done on the power source panel. When changing values from the power source panel are not supported by the remote control, the remote control display will show the previous supported value.

### 3.4 Set value

1. Press the button (2) on the remote control to toggle between the available functions (1) and select a function.
2. Rotate the wheel (3) to the left to decrease and to the right to increase the value.
3. The value change is shown in the remote control display. The value on the power source panel display will change accordingly and reflect the change made with the remote control.

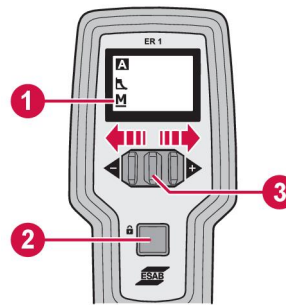

### 3.5 Activate and deactivate memory

1. In the menu, select the memory symbol (1). The memory symbol is highlighted without a memory number.
2. Rotate the wheel (3) to select a memory number. For memory settings, see the power source instruction manual.
3. Press the button (2) to activate the chosen memory. The memory value is shown on the display. The power source reflects the memory value.
4. To deactivate a memory and the values from it, rotate the wheel (3) to change a value or go to memory mode and select *Empty memory* (no number).



### 3.6 Lock and unlock the remote control

1. Press and hold the button (2) for 2 seconds to lock the remote control for interaction.
2. A big lock symbol will appear shortly on the display. A small lock symbol (1) is shown in the right corner to indicate that the remote control is locked for interaction.
3. To unlock the remote control press and hold the button (2) for 2 seconds. An unlock symbol indicates that the remote control is unlocked.

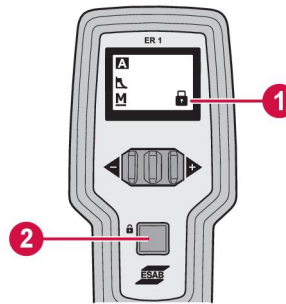

### 3.7 Deactivate the remote control

#### When connected to a power source with manual activation:

1. Deactivate the remote control from the power source as described in the instruction manual for the power source.
2. When the remote control is deactivated, the remote control is inactive and locked for interaction.



#### When connected to a power source with automatic activation:

1. Unplug the remote control from the power source to deactivate the remote control as described in the instruction manual for the power source.

---

## 4 OPERATION ER 1F

---

### 4.1 Start up

The remote control ER 1F (foot pedal) is used for TIG welding only.

Connect the foot pedal to the power source as described in the instruction manual for the power source.

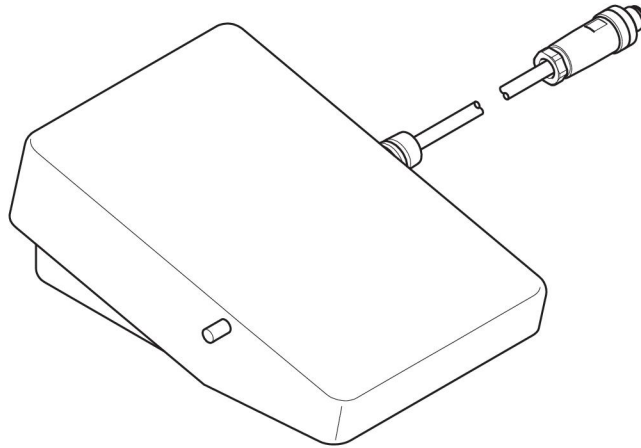

### 4.2 Activate the foot pedal

**When connected to a power source with manual activation:**

1. Activate the foot pedal from the power source as described in the instruction manual for the power source.
2. Use the foot pedal for weld start and control of welding current. The available current range depend on the settings made on the power source.

It is possible to change current value from the power source panel. The power source panel will be locked for all other interaction, but will reflect the value changes done with the foot pedal.

**When connected to a power source with automatic activation:**

1. The foot pedal is activated when connected to the power source.
2. Use the foot pedal for weld start and setting of welding current. The available current range depend on the settings made on the power source. The power source panel and the foot pedal are both active.



### 4.3 Deactivate the foot pedal

**When connected to a power source with manual activation**

Deactivate the foot pedal from the power source as described in the instruction manual for the power source.



**When connected to a power source with automatic activation**

Unplug the foot pedal from the power source to deactivate the remote control as described in the instruction manual for the power source.

## 5 MAINTENANCE

**DANGER!**

Disconnect the power supply when engaged in electrical enclosures and electric motors. Work with high voltage upon contact may result in death.

**WARNING!**

Maintenance and repair work should be performed by an experienced person, and electrical work only by a trained electrician.

- Inspect all cables.
- Check all electrical connections.

### 5.1 Replace cable ER 1

1. Remove the five screws (1).
2. Remove the back cover of the remote control (2).
3. Remove the three screws (3).
4. Remove the connectors.
5. Replace the cable.
6. Insert the connectors and tighten the screws using the correct tightening torque according to the illustration.
7. Replace the back cover.

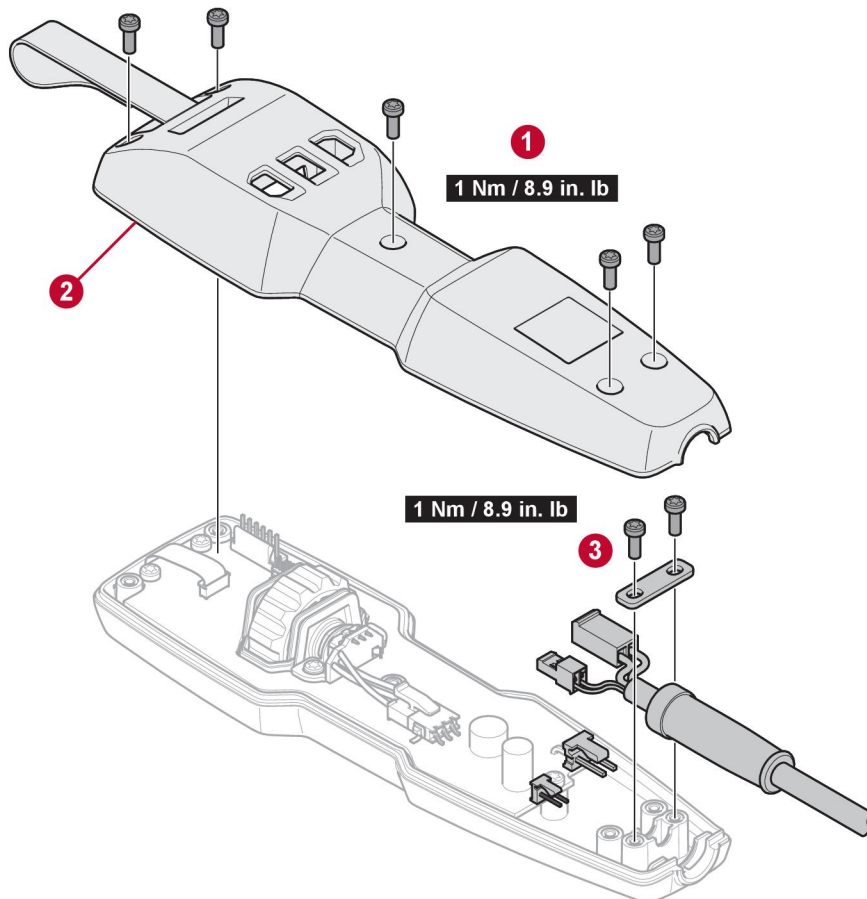

## 5.2 Replace cable ER 1F

1. Press the two spring latches (1) to release the top cover.
2. Press and release the cable gland (2). The PCBA and connectors are covered by an IP protection sheet.
3. Remove the connectors (3).
4. Remove the screw connecting the shield of cable to the metal plate used for mounting the PCBA (4).
5. Replace the cable.
6. Insert the connectors (3).
7. Ensure that the IP protection sheet is covering the PCBA and connectors.
8. Replace the top cover.

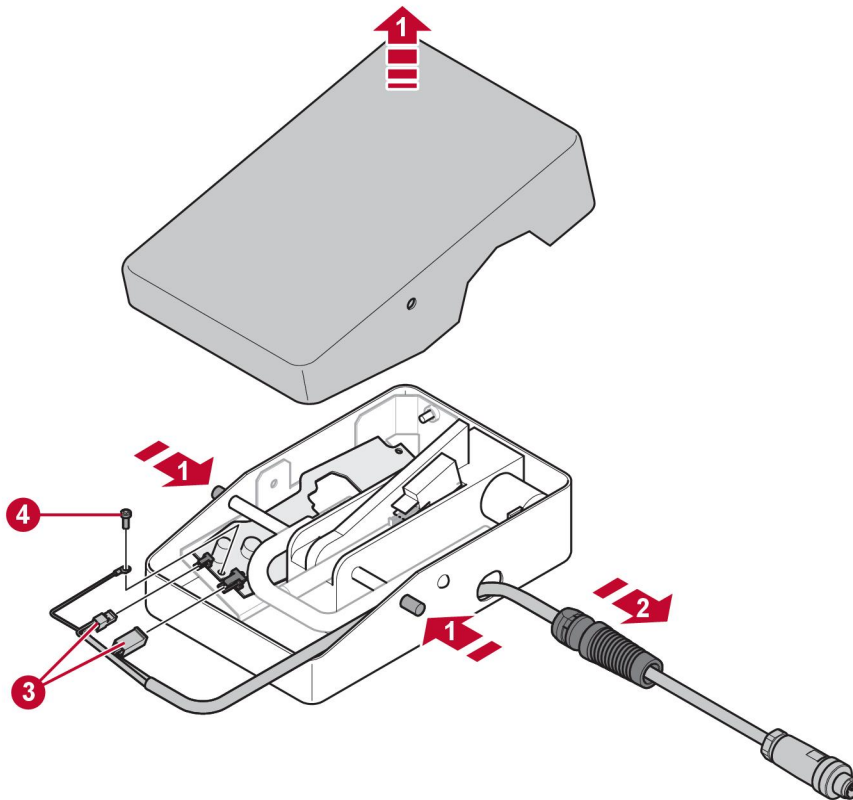

## **6 TROUBLESHOOTING**

---

For troubleshooting and error codes, see the power source instruction manual.

---

## 7 ORDERING NUMBERS

---

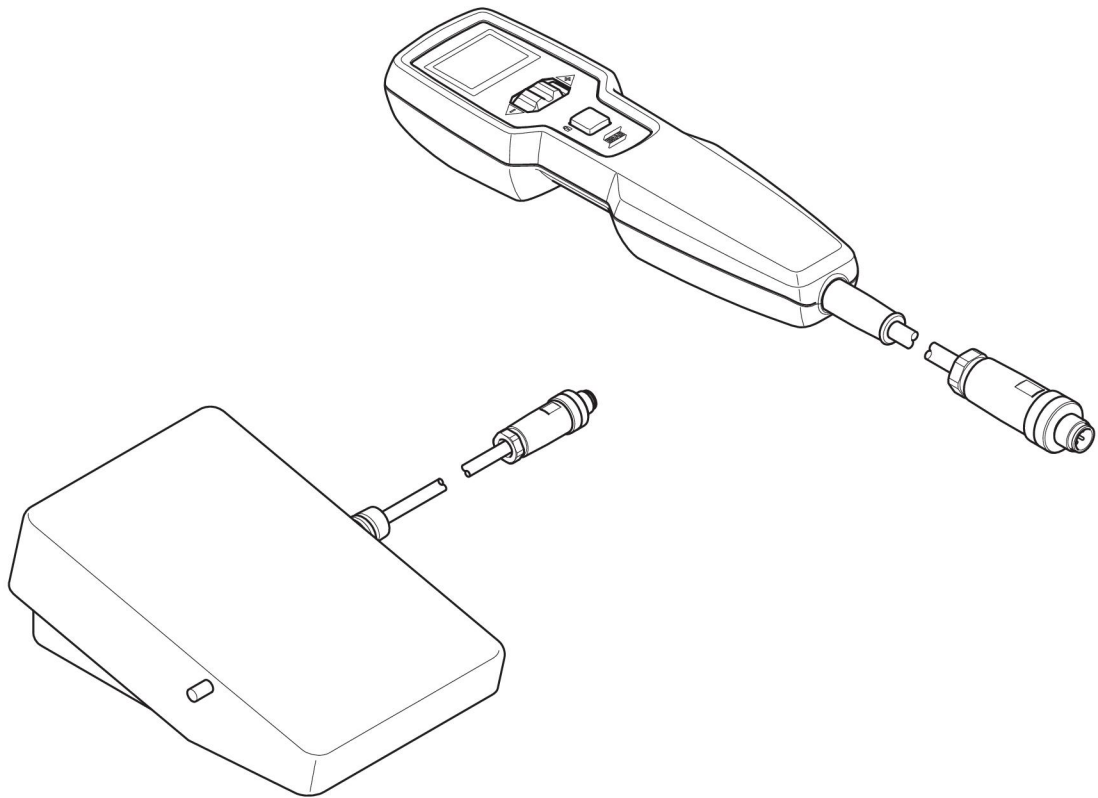

Ordering number	Denomination	Type
0445 536 880	ER 1 Remote control with 4 pin, 5 m (16.4 ft) cable	Handheld remote
0445 536 881	ER 1 Remote control with 6 pin, 5 m (16.4 ft) cable	Handheld remote
0445 536 882	ER 1 Remote control with 6 pin, 10 m (32.8 ft) cable	Handheld remote
0445 536 883	ER 1 Remote control with 6 pin, 25 m (82 ft) cable	Handheld remote
0445 550 880	ER 1F Remote control with 4 pin, 5 m (16.4 ft) cable	Foot pedal
0445 550 881	ER 1F Remote control with 6 pin, 5 m (16.4 ft) cable	Foot pedal
0445 550 882	ER 1F Remote control with 6 pin, 10 m (32.8 ft) cable	Foot pedal

## 8 ORDERING SPARE PARTS

---



**CAUTION!**

Repair and electrical work should be performed by an authorised ESAB service technician. Use only ESAB original spare and wear parts.

Spare parts and wear parts can be ordered through your nearest ESAB dealer, see the back cover of this document. When ordering, please state product type, serial number, designation and spare part number in accordance with the spare parts list. This facilitates dispatch and ensures correct delivery.

## 9 ACCESSORIES

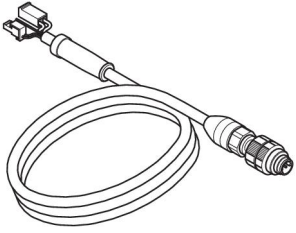
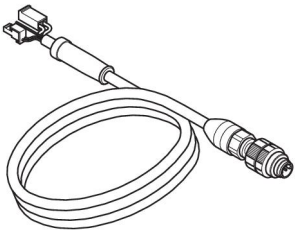
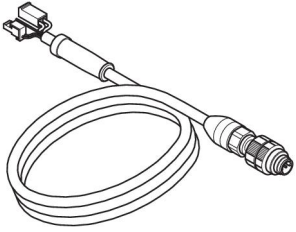
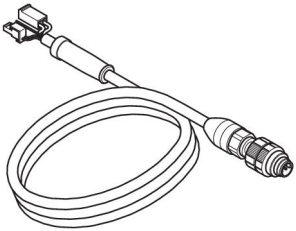
<b>ER 1 (0445 536 880)</b>		
0445 450 880	Interconnection cable, 4 pin, 5 m (16.4 ft)	
<b>ER 1 (0445 536 881)</b>		
0445 280 880	Interconnection cable, 6 pin, 5 m (16.4 ft)	
0445 280 881	Interconnection cable, 6 pin, 10 m (32.8 ft)	
0445 280 882	Interconnection cable, 6 pin, 25 m (82.0 ft)	
<b>ER 1F (0445 550 880)</b>		
0445 451 880	Interconnection cable, 4 pin, 5 m (16.4 ft)	
<b>ER 1F (0445 550 881)</b>		
0445 254 880	Interconnection cable, 6 pin, 5 m (16.4 ft)	
0445 254 881	Interconnection cable, 6 pin, 10 m (32.8 ft)	





# ESAB subsidiaries and representative offices

## Europe

### AUSTRIA

ESAB Ges.m.b.H  
Vienna-Liesing  
Tel: +43 1 888 25 11  
Fax: +43 1 888 25 11 85

### BELGIUM

S.A. ESAB N.V.  
Heist-op-den-Berg  
Tel: +32 15 25 79 30  
Fax: +32 15 25 79 44

### BULGARIA

ESAB Kft Representative Office  
Sofia  
Tel: +359 2 974 42 88  
Fax: +359 2 974 42 88

### THE CZECH REPUBLIC

ESAB VAMBERK s.r.o.  
Vamberk  
Tel: +420 2 819 40 885  
Fax: +420 2 819 40 120

### DENMARK

Aktieselskabet ESAB  
Herlev  
Tel: +45 36 30 01 11  
Fax: +45 36 30 40 03

### FINLAND

ESAB Oy  
Helsinki  
Tel: +358 9 547 761  
Fax: +358 9 547 77 71

### GREAT BRITAIN

ESAB Group (UK) Ltd  
Waltham Cross  
Tel: +44 1992 76 85 15  
Fax: +44 1992 71 58 03

ESAB Automation Ltd  
Andover

Tel: +44 1264 33 22 33  
Fax: +44 1264 33 20 74

### FRANCE

ESAB France S.A.  
Cergy Pontoise  
Tel: +33 1 30 75 55 00  
Fax: +33 1 30 75 55 24

### GERMANY

ESAB Welding & Cutting GmbH  
Langenfeld  
Tel: +49 2173 3945-0  
Fax: +49 2173 3945-218

### HUNGARY

ESAB Kft  
Budapest  
Tel: +36 1 20 44 182  
Fax: +36 1 20 44 186

### ITALY

ESAB Saldatura S.p.A.  
Bareggio (Mi)  
Tel: +39 02 97 96 8.1  
Fax: +39 02 97 96 87 01

## THE NETHERLANDS

ESAB Nederland B.V.  
Amersfoort  
Tel: +31 33 422 35 55  
Fax: +31 33 422 35 44

## NORWAY

AS ESAB  
Larvik  
Tel: +47 33 12 10 00  
Fax: +47 33 11 52 03

## POLAND

ESAB Sp.zo.o.  
Katowice  
Tel: +48 32 351 11 00  
Fax: +48 32 351 11 20

## PORTUGAL

ESAB Lda  
Lisbon  
Tel: +351 8 310 960  
Fax: +351 1 859 1277

## ROMANIA

ESAB Romania Trading SRL  
Bucharest  
Tel: +40 316 900 600  
Fax: +40 316 900 601

## RUSSIA

LLC ESAB  
Moscow  
Tel: +7 (495) 663 20 08  
Fax: +7 (495) 663 20 09

## SLOVAKIA

ESAB Slovakia s.r.o.  
Bratislava  
Tel: +421 7 44 88 24 26  
Fax: +421 7 44 88 87 41

## SPAIN

ESAB Ibérica S.A.  
San Fernando de Henares  
(MADRID)  
Tel: +34 91 878 3600  
Fax: +34 91 802 3461

## SWEDEN

ESAB Sverige AB  
Gothenburg  
Tel: +46 31 50 95 00  
Fax: +46 31 50 92 22

ESAB International AB

Gothenburg  
Tel: +46 31 50 90 00  
Fax: +46 31 50 93 60

## SWITZERLAND

ESAB Europe GmbH  
Baar  
Tel: +41 1 741 25 25  
Fax: +41 1 740 30 55

## UKRAINE

ESAB Ukraine LLC  
Kiev  
Tel: +38 (044) 501 23 24  
Fax: +38 (044) 575 21 88

## North and South America

### ARGENTINA

CONARCO  
Buenos Aires  
Tel: +54 11 4 753 4039  
Fax: +54 11 4 753 6313

### BRAZIL

ESAB S.A.  
Contagem-MG  
Tel: +55 31 2191 4333  
Fax: +55 31 2191 4440

### CANADA

ESAB Group Canada Inc.  
Mississauga, Ontario  
Tel: +1 905 670 0220  
Fax: +1 905 670 4879

### MEXICO

ESAB Mexico S.A.  
Monterrey  
Tel: +52 8 350 5959  
Fax: +52 8 350 7554

### USA

ESAB Welding & Cutting  
Products  
Florence, SC  
Tel: +1 843 669 4411  
Fax: +1 843 664 5748

## Asia/Pacific

### AUSTRALIA

ESAB South Pacific  
Archerfield BC QLD 4108  
Tel: +61 1300 372 228  
Fax: +61 7 3711 2328

### CHINA

Shanghai ESAB A/P  
Shanghai  
Tel: +86 21 2326 3000  
Fax: +86 21 6566 6622

### INDIA

ESAB India Ltd  
Calcutta  
Tel: +91 33 478 45 17  
Fax: +91 33 468 18 80

### INDONESIA

P.T. ESABindo Pratama  
Jakarta  
Tel: +62 21 460 0188  
Fax: +62 21 461 2929

### JAPAN

ESAB Japan  
Tokyo  
Tel: +81 45 670 7073  
Fax: +81 45 670 7001

### MALAYSIA

ESAB (Malaysia) Snd Bhd  
USJ  
Tel: +603 8023 7835  
Fax: +603 8023 0225

### SINGAPORE

ESAB Asia/Pacific Pte Ltd  
Singapore  
Tel: +65 6861 43 22  
Fax: +65 6861 31 95

## SOUTH KOREA

ESAB SeAH Corporation  
Kyungnam  
Tel: +82 55 269 8170  
Fax: +82 55 289 8864

## UNITED ARAB EMIRATES

ESAB Middle East FZE  
Dubai  
Tel: +971 4 887 21 11  
Fax: +971 4 887 22 63

## Africa

### EGYPT

ESAB Egypt  
Dokki-Cairo  
Tel: +20 2 390 96 69  
Fax: +20 2 393 32 13

### SOUTH AFRICA

ESAB Africa Welding & Cutting  
Ltd  
Durbanville 7570 - Cape Town  
Tel: +27 (0)21 975 8924

## Distributors

*For addresses and phone numbers to our distributors in other countries, please visit our home page*

[www.esab.com](http://www.esab.com)



[www.esab.com](http://www.esab.com)

